

Work Instruction Number 109 - Workforce in Road Signs (Rehabilitation Works)
 All Amberon Traffic Management installations or Removals on any main road or approaching road works 40mph and above (unless the site specific risk assessment deems it necessary on lower speeds of 40mph) must display the Workforce in Road Sign, this being the 1st Sign out and last sign in.

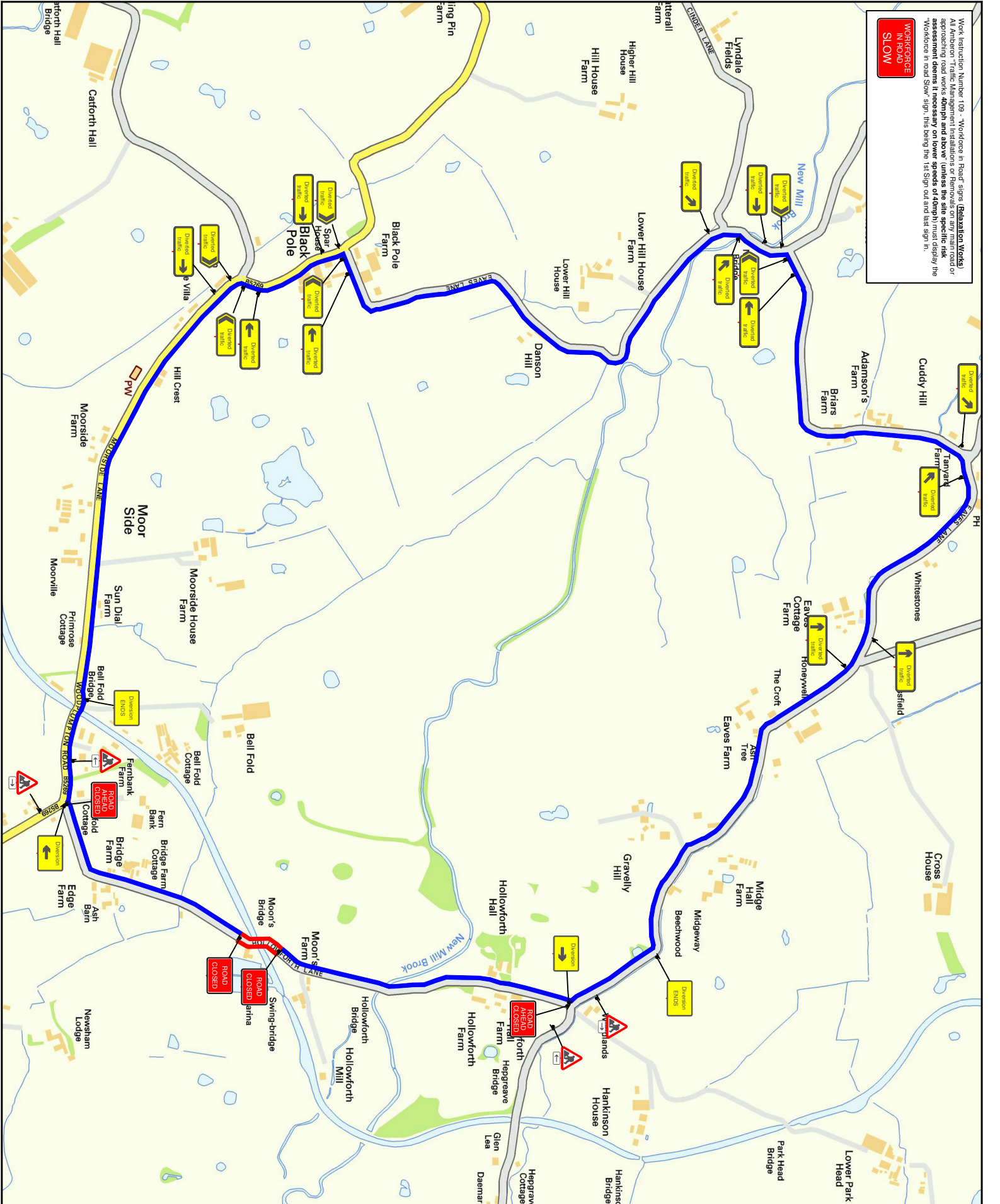

TRAFFIC MANAGEMENT NOTES:
 1) All temporary traffic management shall be in accordance with Chapter 8 of the Traffic Signs
 2) All temporary traffic management shall be in accordance with the Traffic Signs (Amendment) 2012 Regulations and General Directions 2010
 3) The site specific risk assessment shall be carried out to the safety of Street Works and Road Works. A code of Practice traffic management signs should be located 450mm min from the kerb face.
 4) All temporary traffic management sign locations from the Edge view.

Key

- Traffic sign
- Traffic cone/cylinder
- No waiting cone
- Pedestrian barrier
- Road closure
- Diversion route

Checked by: J.Elliott
 Customer: JLF LTD
 Job Reference: hollowforth Lane
 Location: Hollowforth Lane, Canal Bridge, PR4 0BD
 Date: 19.11.18
 Description: Road Closure + Diversion
 Scale: NTS
 Arberon Ltd
 Tel: 0845 371 5050

Produced By: L.Morris
 Drawing Ref: LHM19.11.18.CP.HollowforthLane
 www.amberon.co.uk